

- MORTISE LOCK - SPECIFICATIONS

FRONT VIEW

INSIDE VIEW

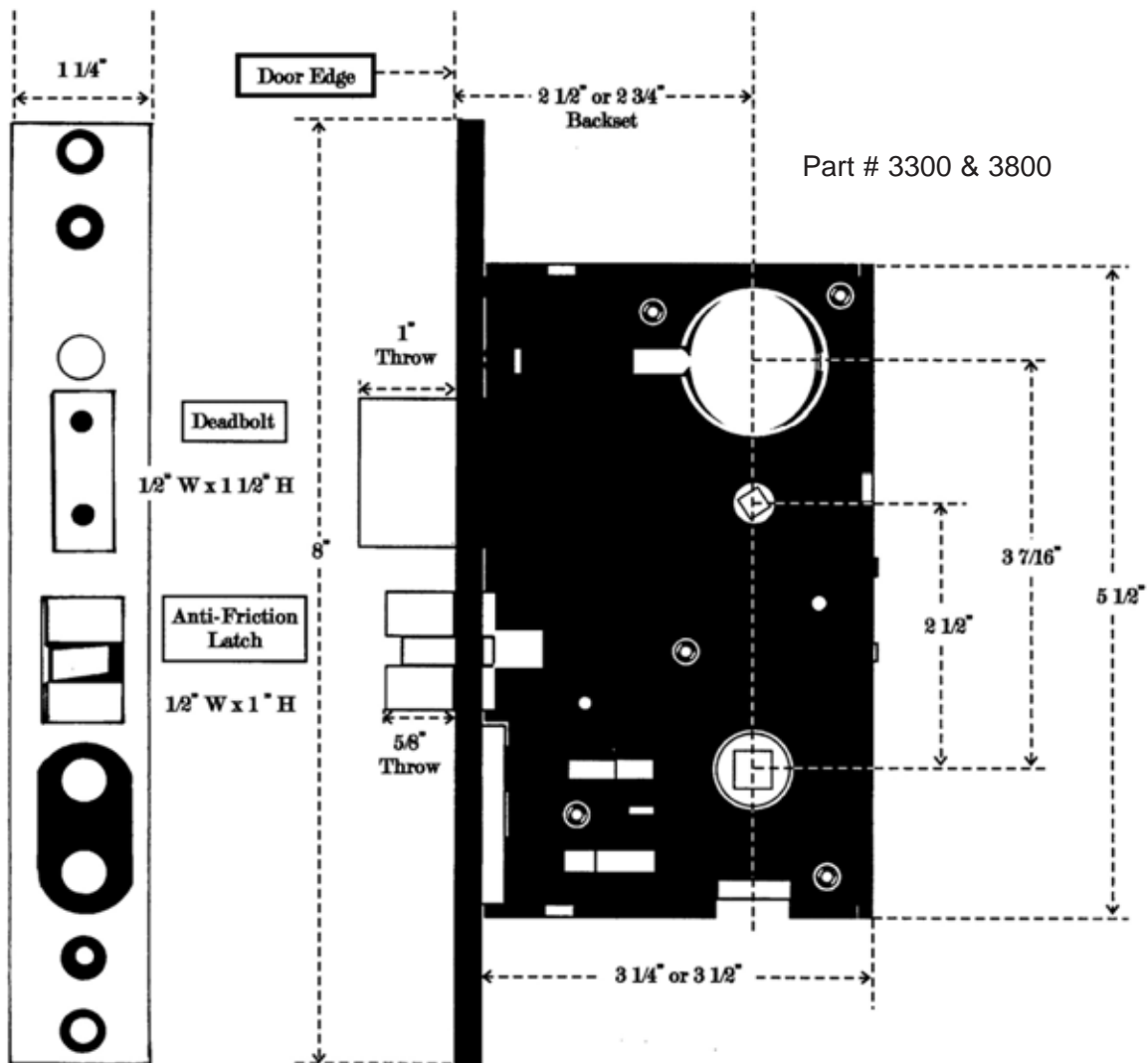

• REFERENCE ONLY

- NOT INTENDED AS DOOR PREPARATION GUIDE
- SEE TEMPLATE FOR INSTALLATION SPECIFICATIONS

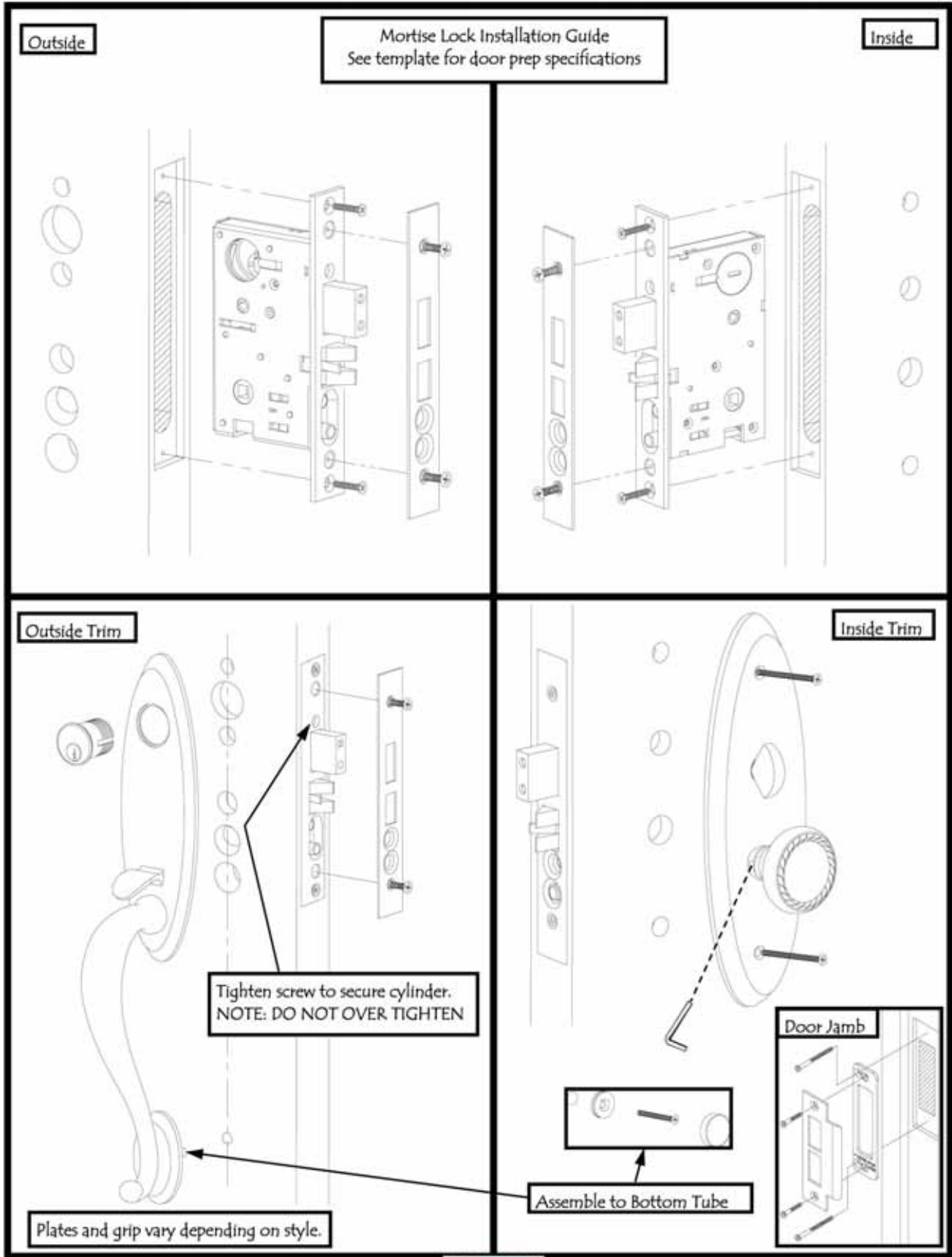

BORING SPECIFICATIONS

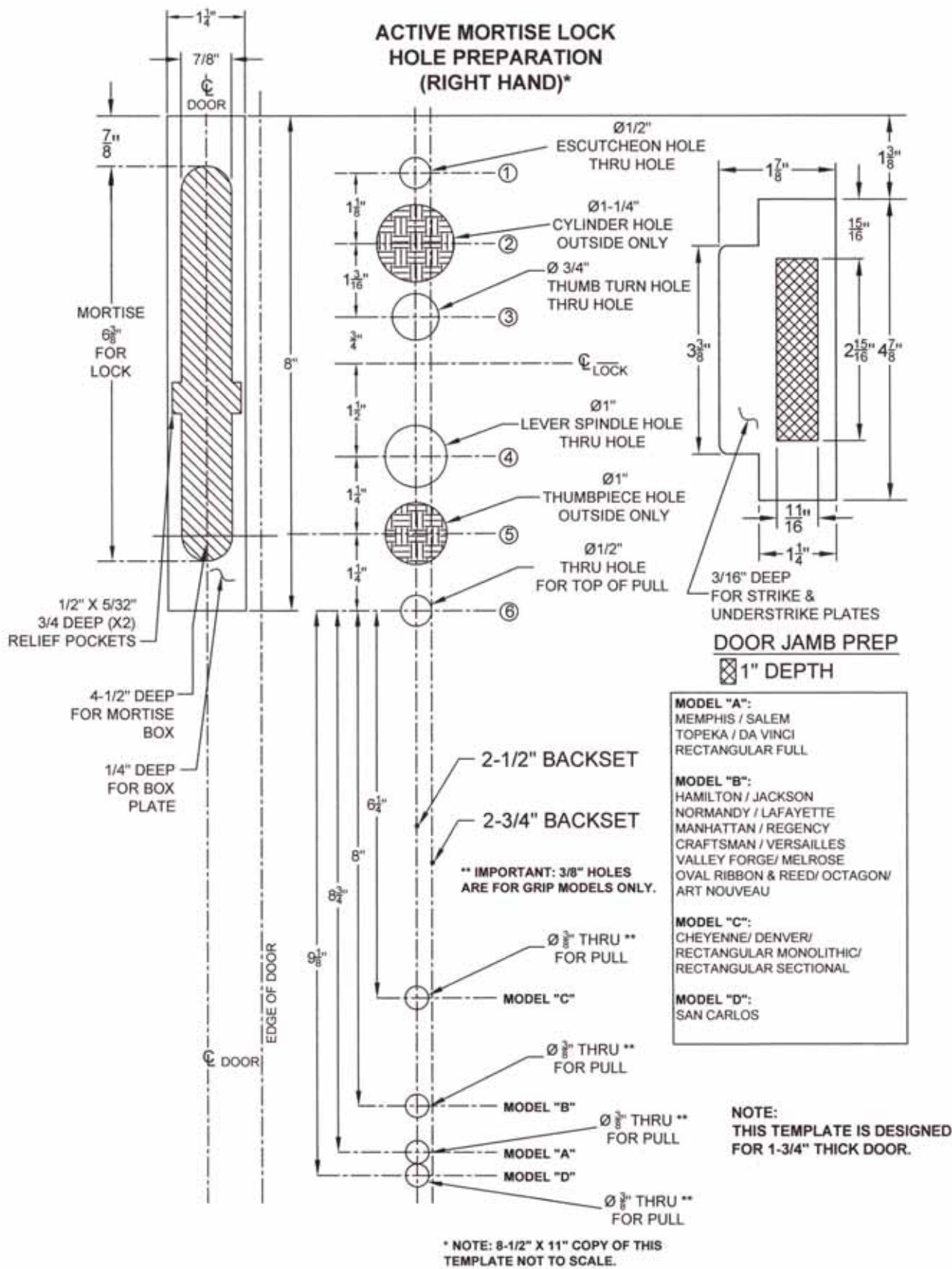

For Reference Only

BORING SPECIFICATIONS

ACTIVE MORTISE LOCK HOLE PREPARATION (LEFT HAND)*

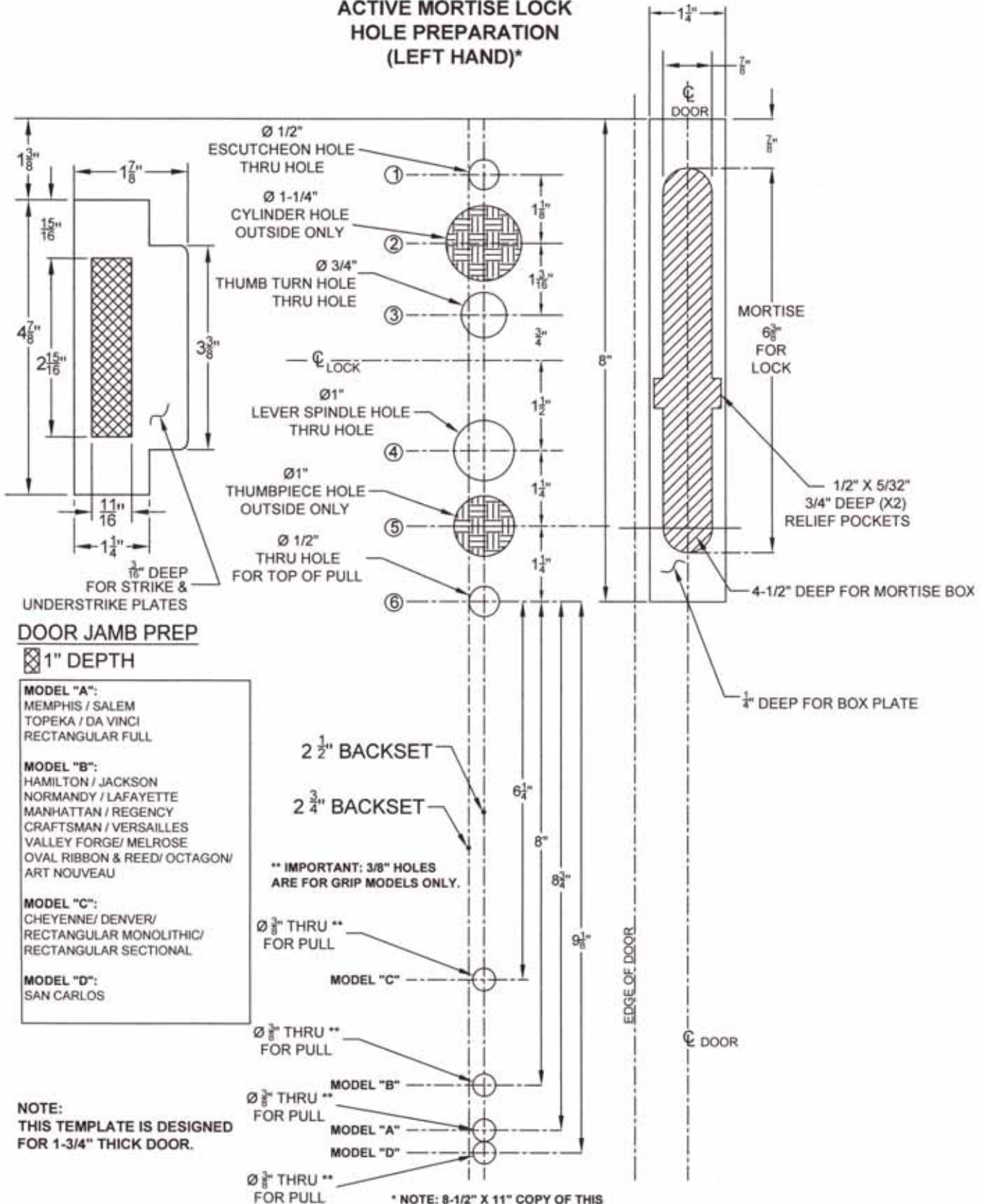

For Reference Only

BORING SPECIFICATIONS (Dummy)

DUMMY MORTISE LOCK HOLE PREPARATION (LEFT HAND) *

<p>MODEL "A": MEMPHIS / SALEM TOPEKA / DA VINCI RECTANGULAR FULL</p> <p>MODEL "B": HAMILTON / JACKSON NORMANDY / LAFAYETTE MANHATTAN / REGENCY CRAFTSMAN / VERSAILLES VALLEY FORGE/ MELROSE OVAL RIBBON & REED/ OCTAGON/ ART NOUVEAU</p> <p>MODEL "C": CHEYENNE/ DENVER/ RECTANGULAR MONOLITHIC/ RECTANGULAR SECTIONAL</p> <p>MODEL "D": SAN CARLOS</p>

** IMPORTANT: 3/8" HOLES
ARE FOR GRIP MODELS ONLY.

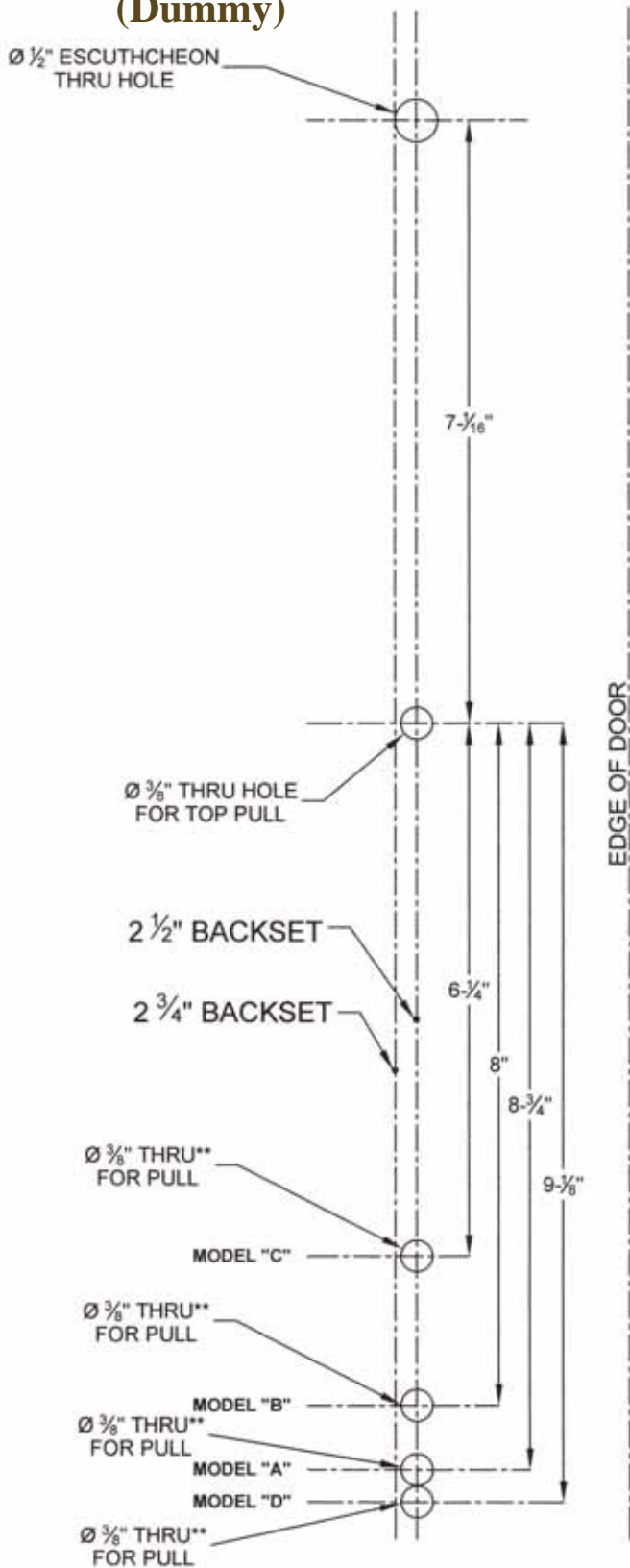

For Reference Only

* NOTE: 8-1/2" X 11" COPY OF THIS
TEMPLATE NOT TO SCALE.

BORING SPECIFICATIONS (Dummy)

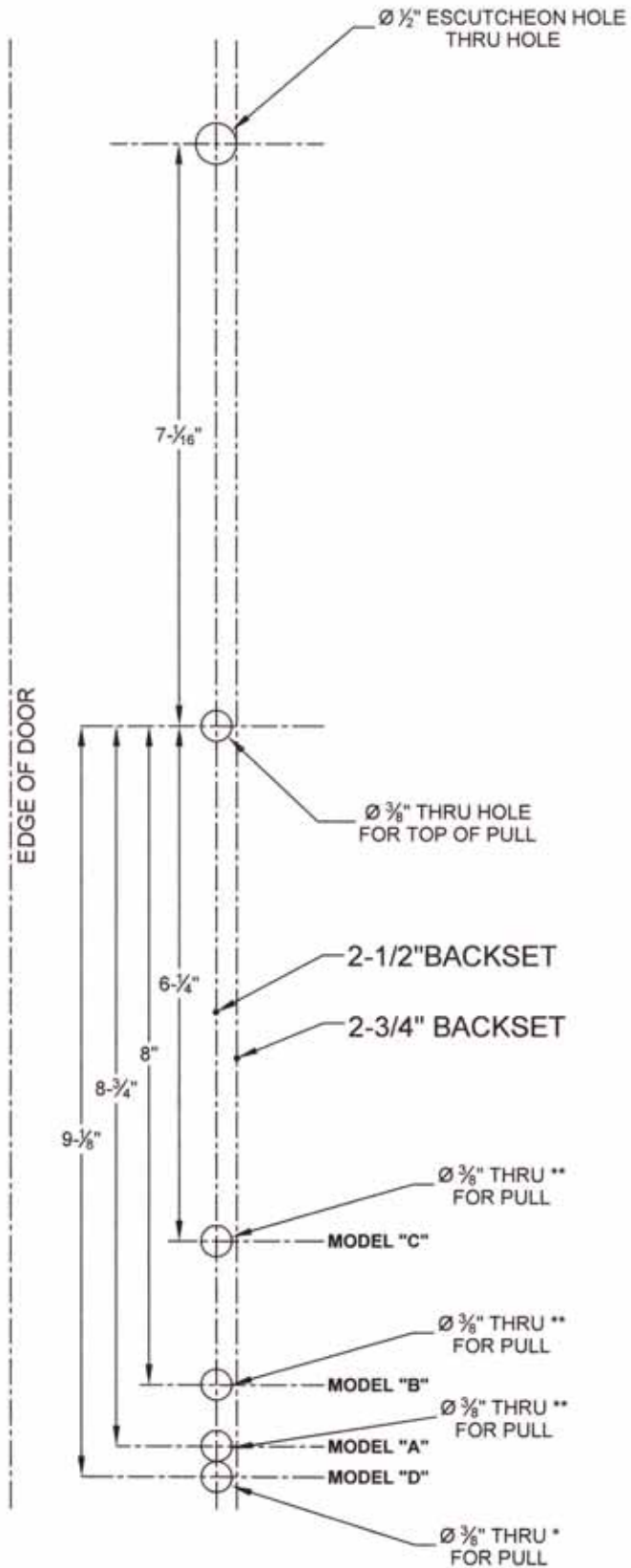

DUMMY MORTISE LOCK HOLE PREPARATION (RIGHT HAND)*

- MODEL "A":**
MEMPHIS / SALEM
TOPEKA / DA VINCI
RECTANGULAR FULL
- MODEL "B":**
HAMILTON / JACKSON
NORMANDY / LAFAYETTE
MANHATTAN / REGENCY
CRAFTSMAN / VERSAILLES
VALLEY FORGE/ MELROSE
OVAL RIBBON & REED/ OCTAGON/
ART NOUVEAU
- MODEL "C":**
CHEYENNE/ DENVER/
RECTANGULAR MONOLITHIC/
RECTANGULAR SECTIONAL
- MODEL "D":**
SAN CARLOS

**** IMPORTANT: Ø 3/8" HOLES
ARE FOR GRIP MODELS ONLY.**

* NOTE: 8-1/2" X 11" COPY OF THIS
TEMPLATE NOT TO SCALE.

For Reference Only